



Oasiz2

BY **DANUBE**

Floor Plans

STUDIO

TYPE - A

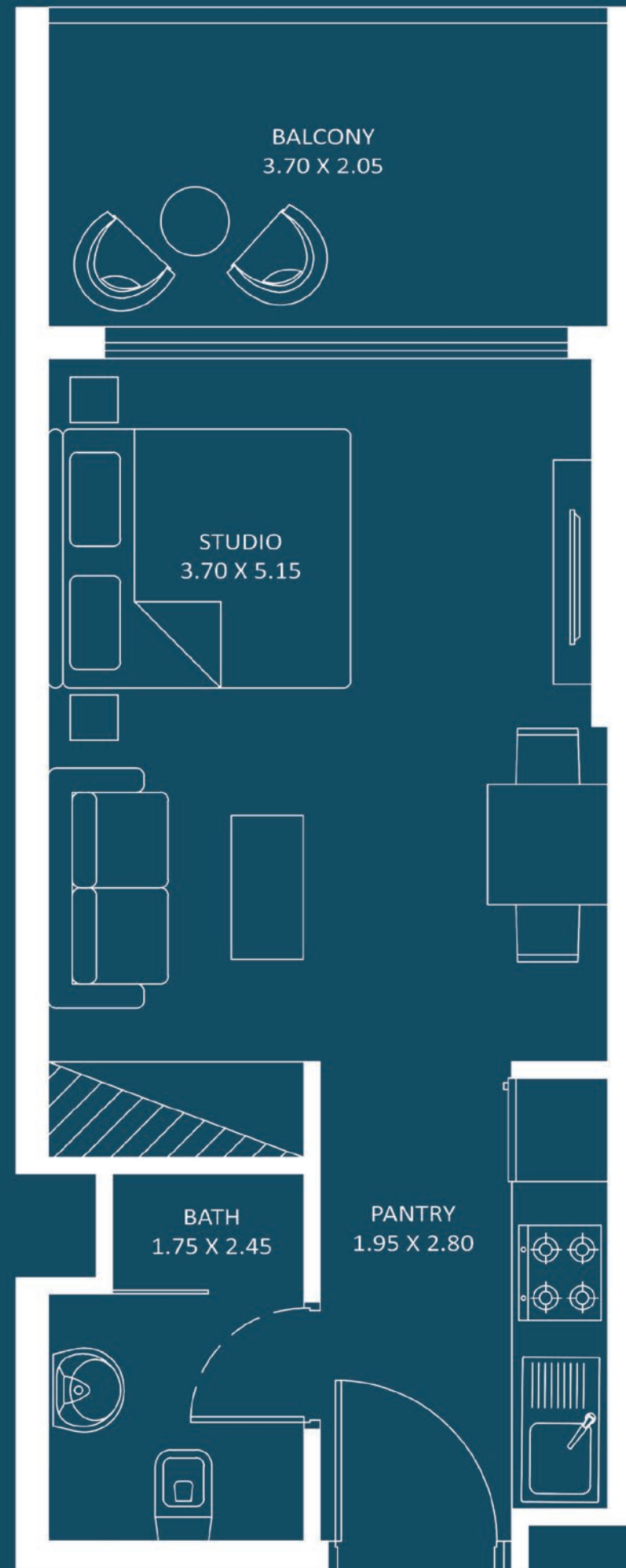

AREA (Sq.Ft)

Apartment
289 to 297

Balcony
78 to 82

Total
367 to 379

Floor

Oasiz 2



2 - 15

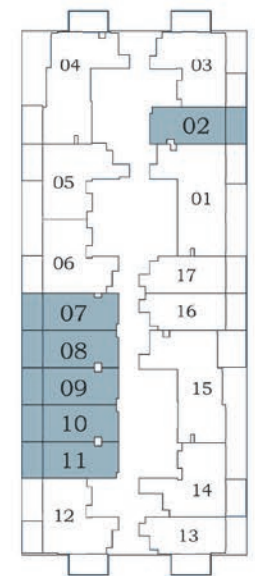

17 - 27

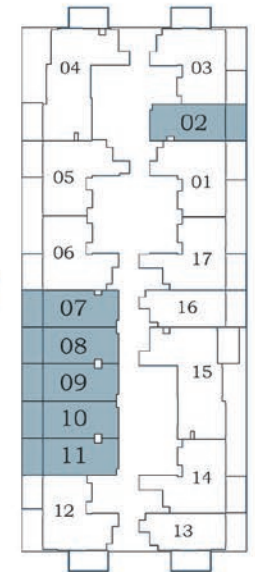

STUDIO
TYPE - B

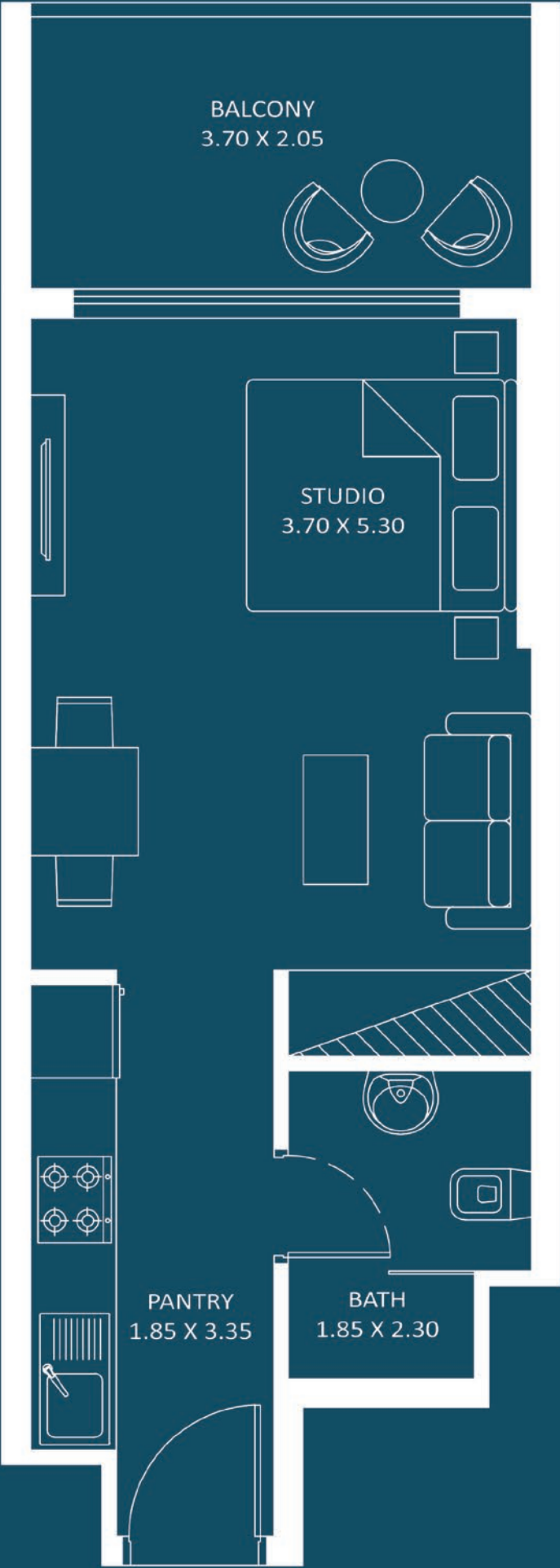

AREA (Sq.Ft)

Apartment

310 to 317

Balcony

77 to 81

Total

387 to 398

Floor

Oasiz 2



2 - 15

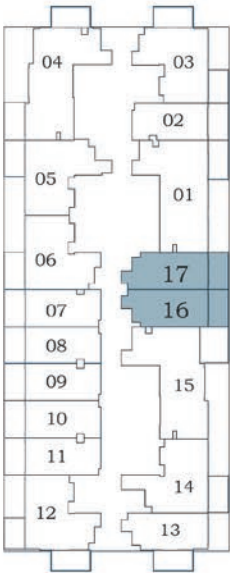

17 - 27

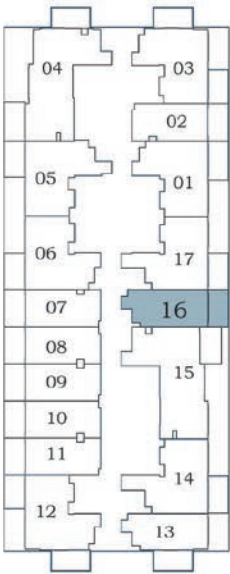

STUDIO

TYPE - C

Floor

Oasiz 2



17 - 27

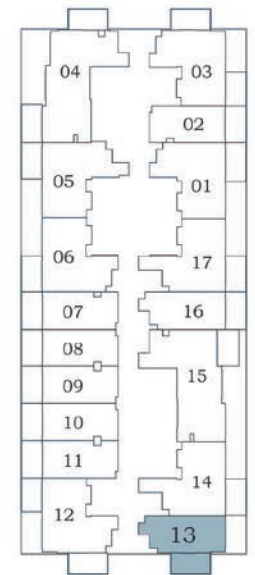

AREA (Sq.Ft)

Apartment
308 to 316

Balcony
82 to 86

Total
390 to 402



PRESIDENTIAL

STUDIO - A

Floor

Oasiz 2



2 - 15

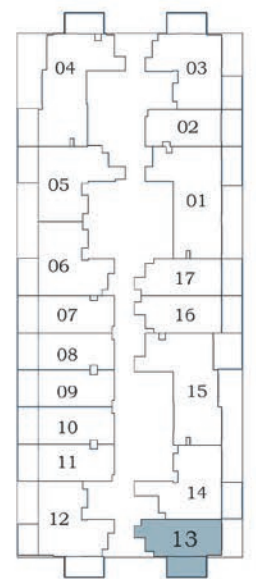

28 - 31

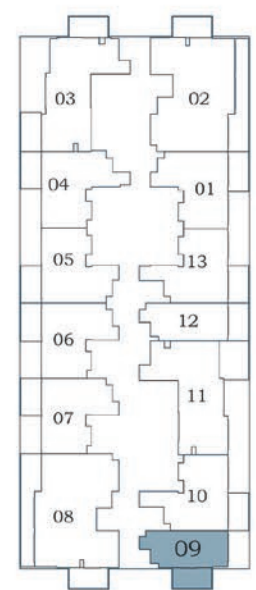

AREA (Sq.Ft)

Apartment
308 to 316

Balcony
82 to 86

Total
390 to 402

FEATURES :

☒ Pool

PRESIDENTIAL

STUDIO - B

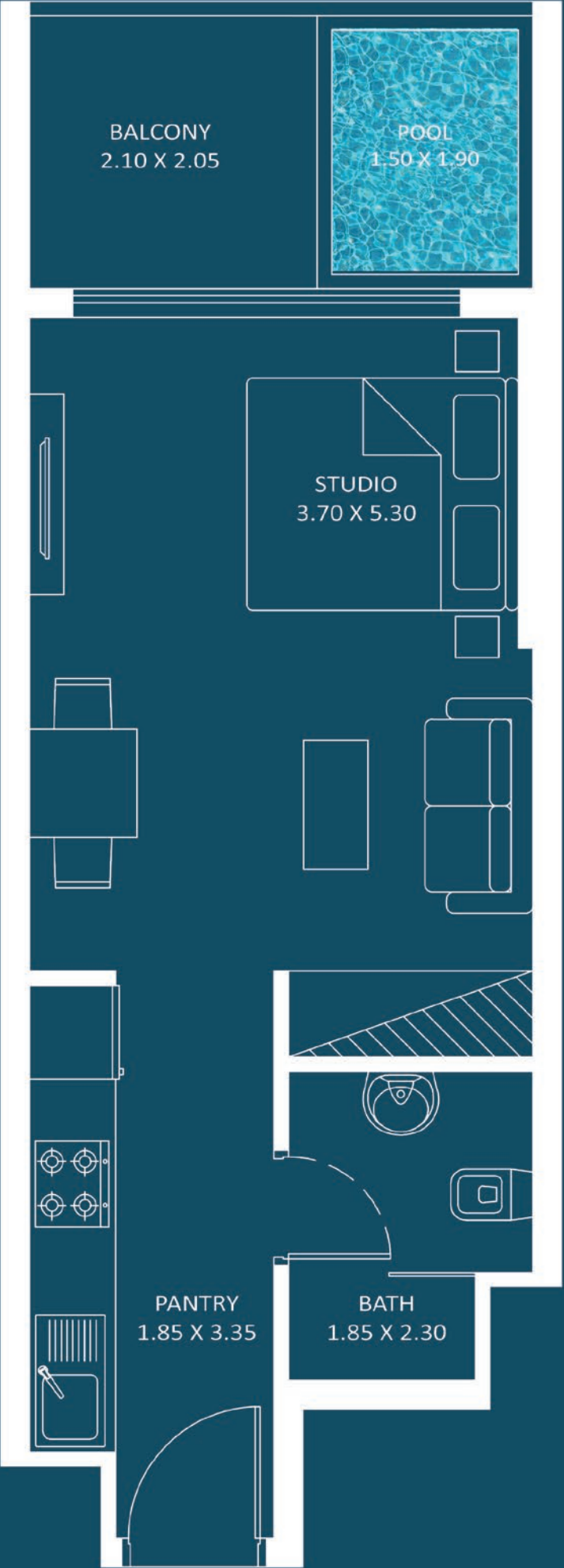
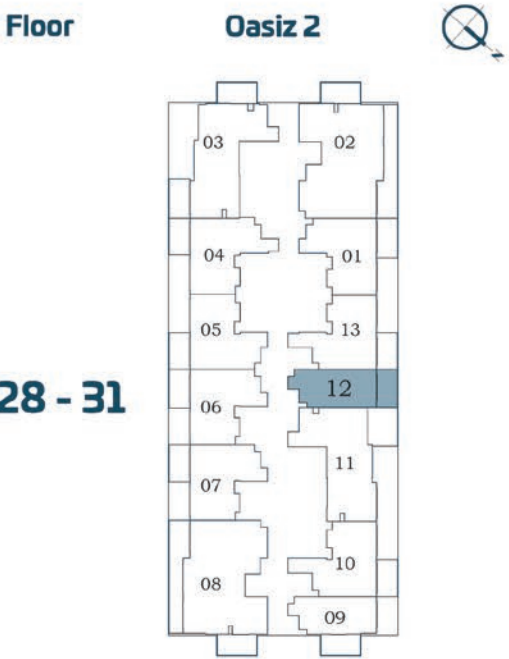

AREA (Sq.Ft)

Apartment
310 to 318

Balcony
77 to 81

Total
387 to 399

FEATURES :

☒ Pool

1 BEDROOM

TYPE - A



AREA (Sq.Ft)

Apartment
455 to 489

Balcony
76 to 86

Total
531 to 565

FEATURES :

☒ Dual Access Bath

Floor

Oasis 2



2 - 15

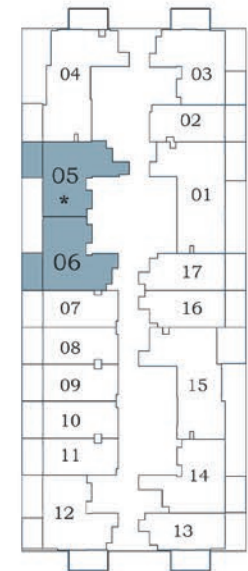

17 - 27

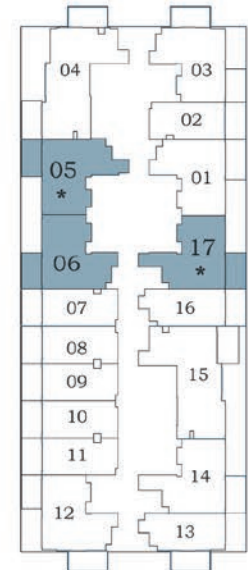

28 - 31

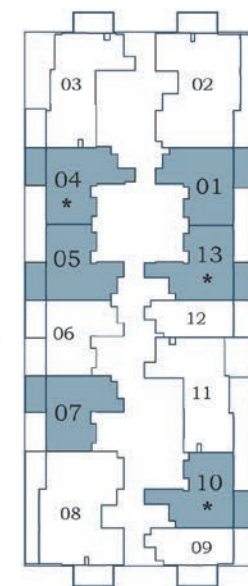

* With foyer

1 BEDROOM

TYPE - B



AREA (Sq.Ft)

Apartment
463 to 471

Balcony
75 to 80

Total
538 to 551

FEATURES :

☒ Dual Access Bath

Floor

Oasis 2



2 - 15

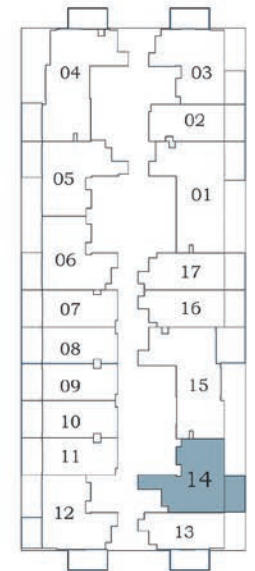

17 - 27

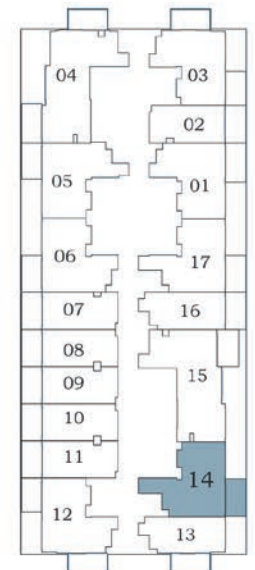

1 BEDROOM

TYPE - C

Floor

Oasis 2



2 - 15

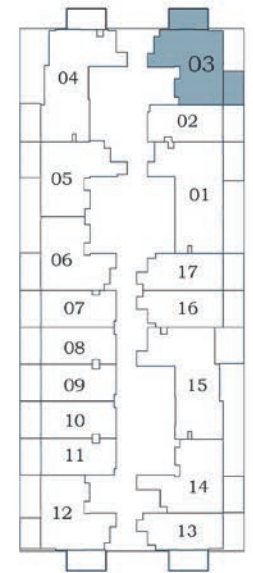

17 - 27

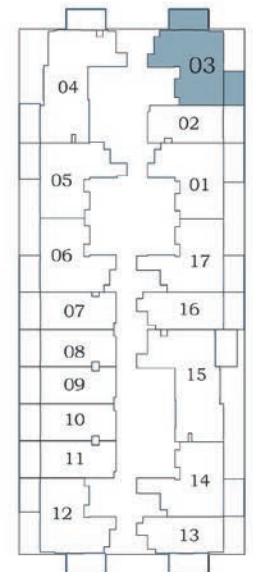

AREA (Sq.Ft)

Apartment
464 to 472

Balcony
155 to 159

Total
619 to 631

FEATURES :

☒ Dual Access Bath



PRESIDENTIAL

SUITE - A

Floor

Oasiz 2



17 - 27

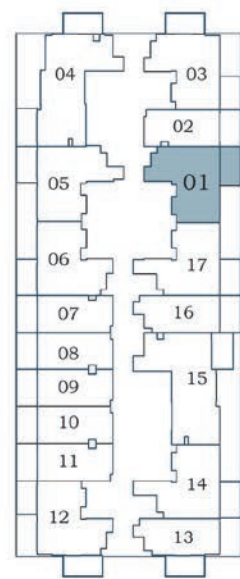

28 - 31

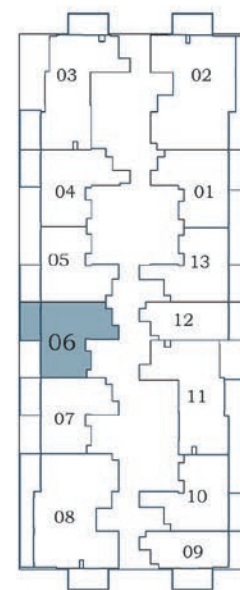

AREA (Sq.Ft)

Apartment
458 to 472

Balcony
78 to 86

Total
536 to 558

FEATURES :

- ☒ Pool
- ☒ Dual Access Bath

PRESIDENTIAL

SUITE - B

Floor

Oasiz 2



2 - 15

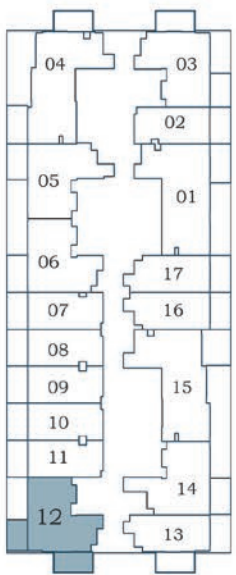

AREA (Sq.Ft)

Apartment
464 to 472

Balcony
150 to 154

Total
614 to 626

FEATURES :

- ☒ Pool
- ☒ Dual Access Bath

PRESIDENTIAL

SUITE - C

Floor

Oasiz 2



17 - 27

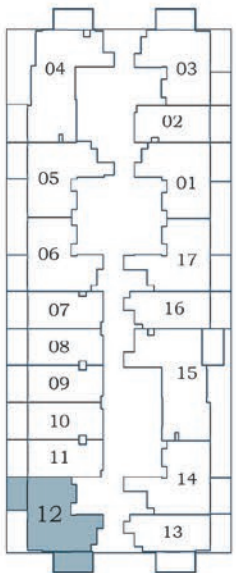

POOL
1.80 X 1.90

BALCONY
1.45 X 2.05



BEDROOM
3.85 X 3.15



BATH
2.65 X 1.75

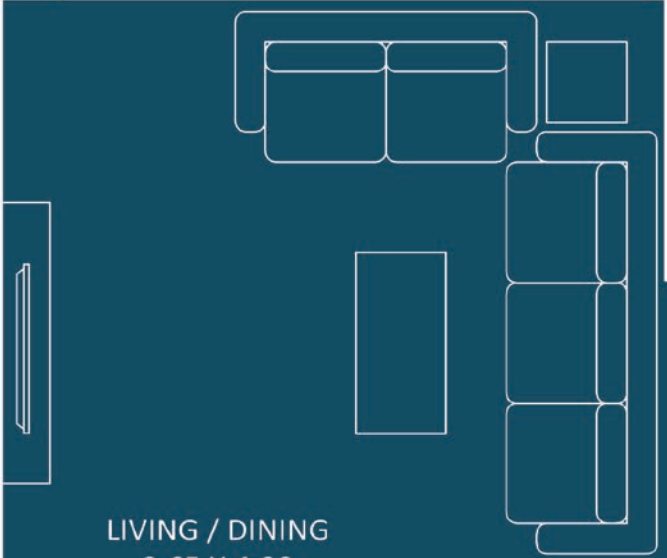

LIVING / DINING
3.65 X 4.90



KITCHEN
3.70 X 2.45

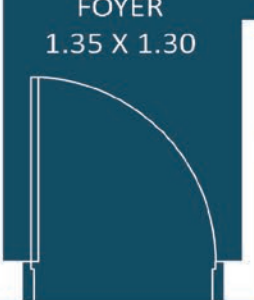

FOYER
1.35 X 1.30

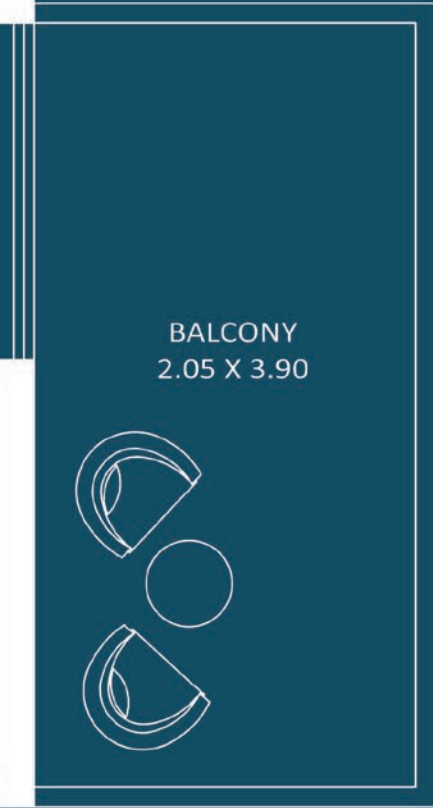

BALCONY
2.05 X 3.90

AREA (Sq.Ft)

Apartment
464 to 472

Balcony
155 to 159

Total
619 to 631

FEATURES :

- ☒ Pool
- ☒ Dual Access Bath

2 BEDROOM

TYPE - A

Floor

Oasis 2



17 - 27

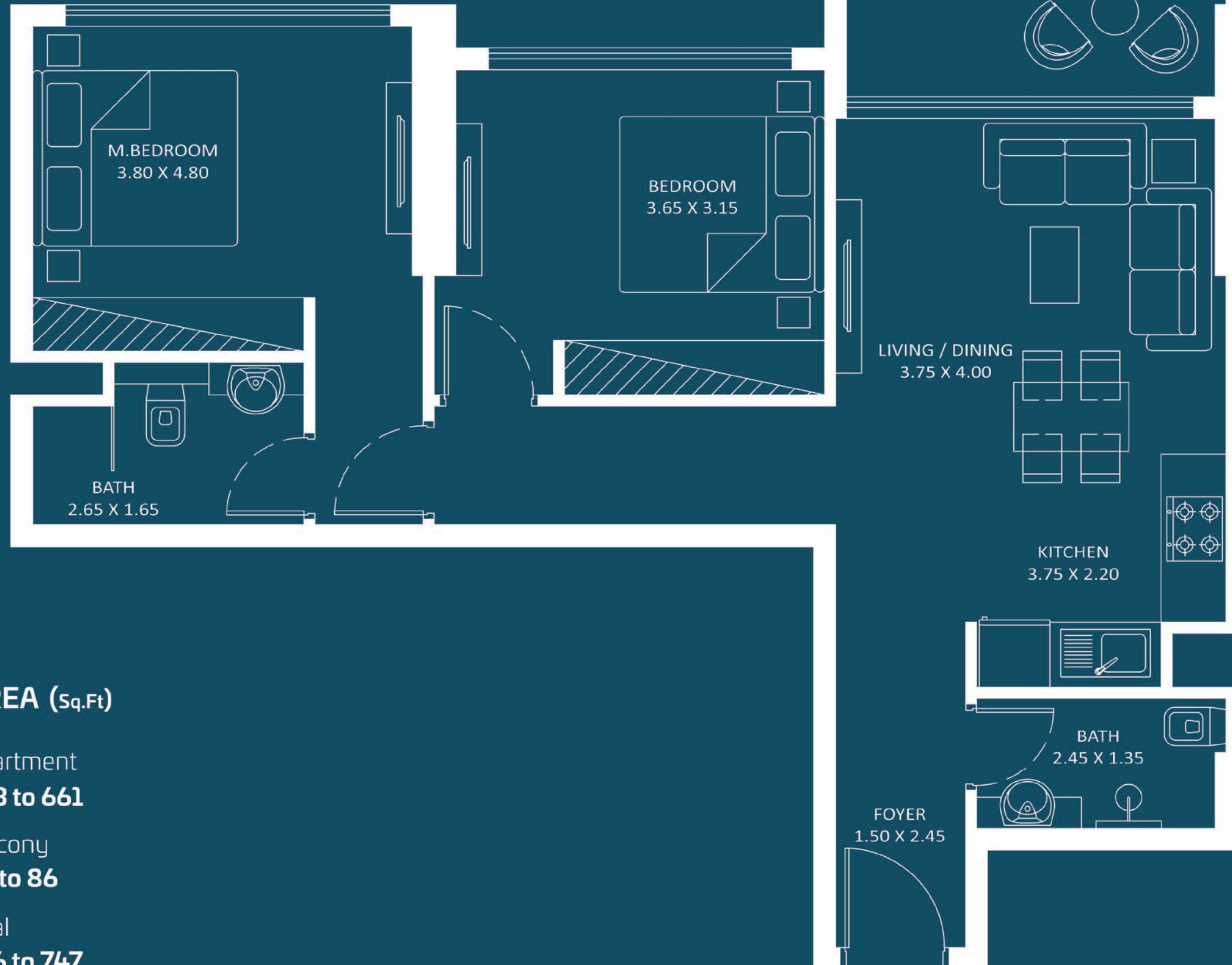
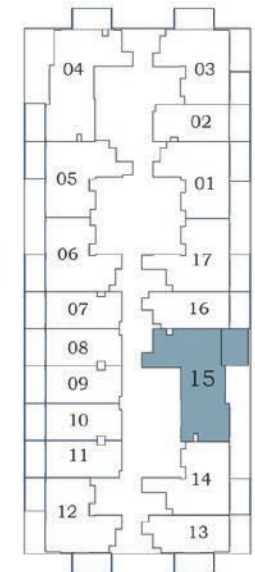

AREA (Sq.Ft)

Apartment
653 to 661

Balcony
83 to 86

Total
736 to 747

2 BEDROOM

TYPE - B

Floor

Oasiz 2



2 - 15

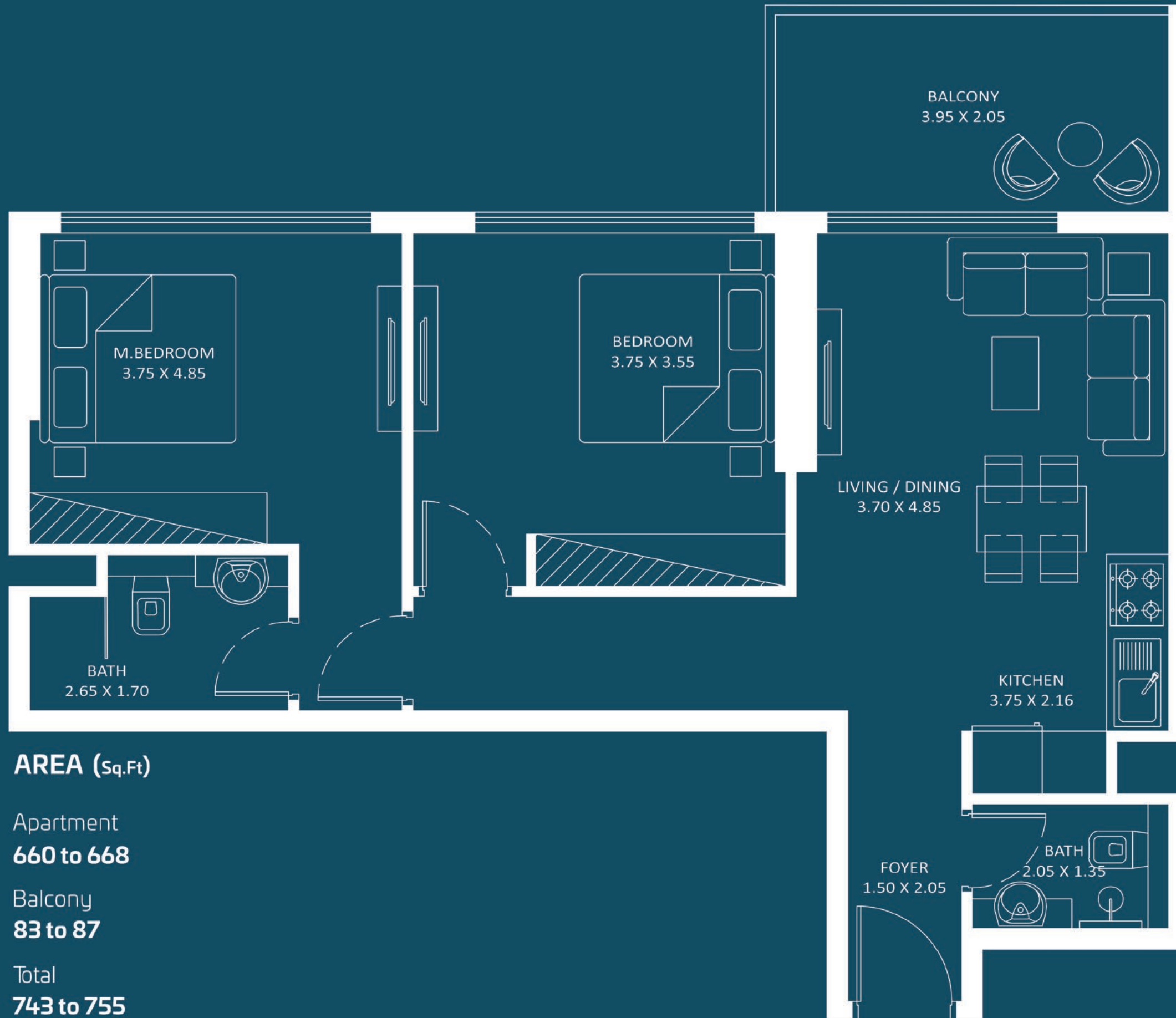
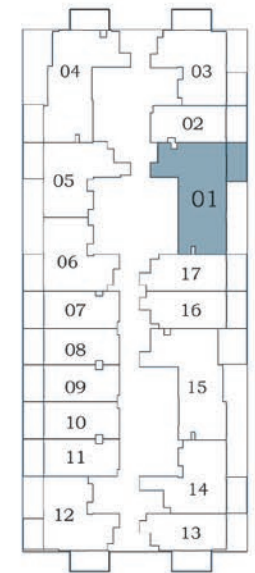

AREA (Sq.Ft)

Apartment
660 to 668

Balcony
83 to 87

Total
743 to 755

2 BEDROOM

TYPE - C

Floor

Oasiz 2

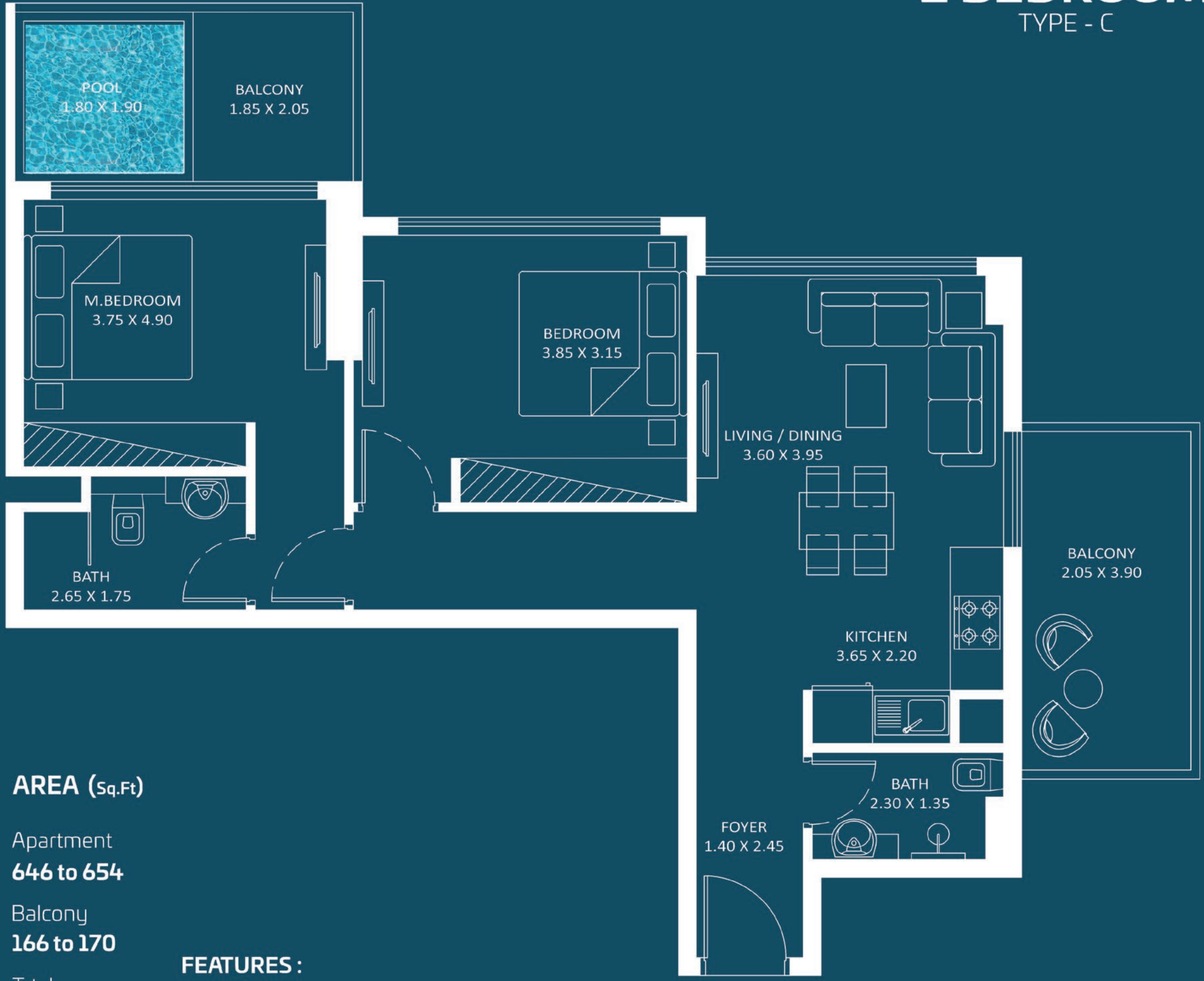

2 - 15

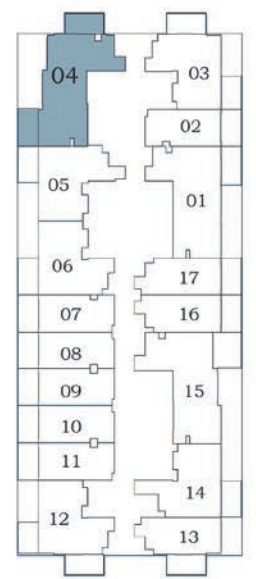

17 - 27

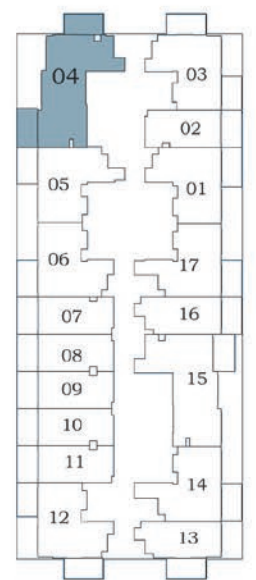

28 - 31

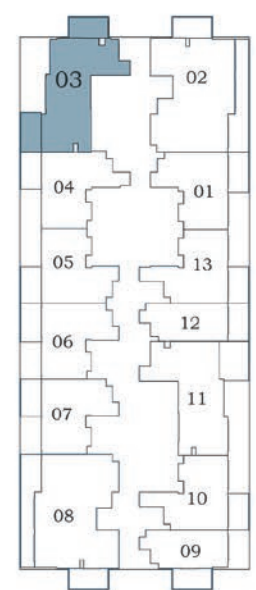

AREA (Sq.Ft)

Apartment
646 to 654

Balcony
166 to 170

Total
812 to 824

FEATURES :

☒ Pool

2 BEDROOM

TYPE - D
WITH POOL

Floor

Oasiz 2



28 - 31

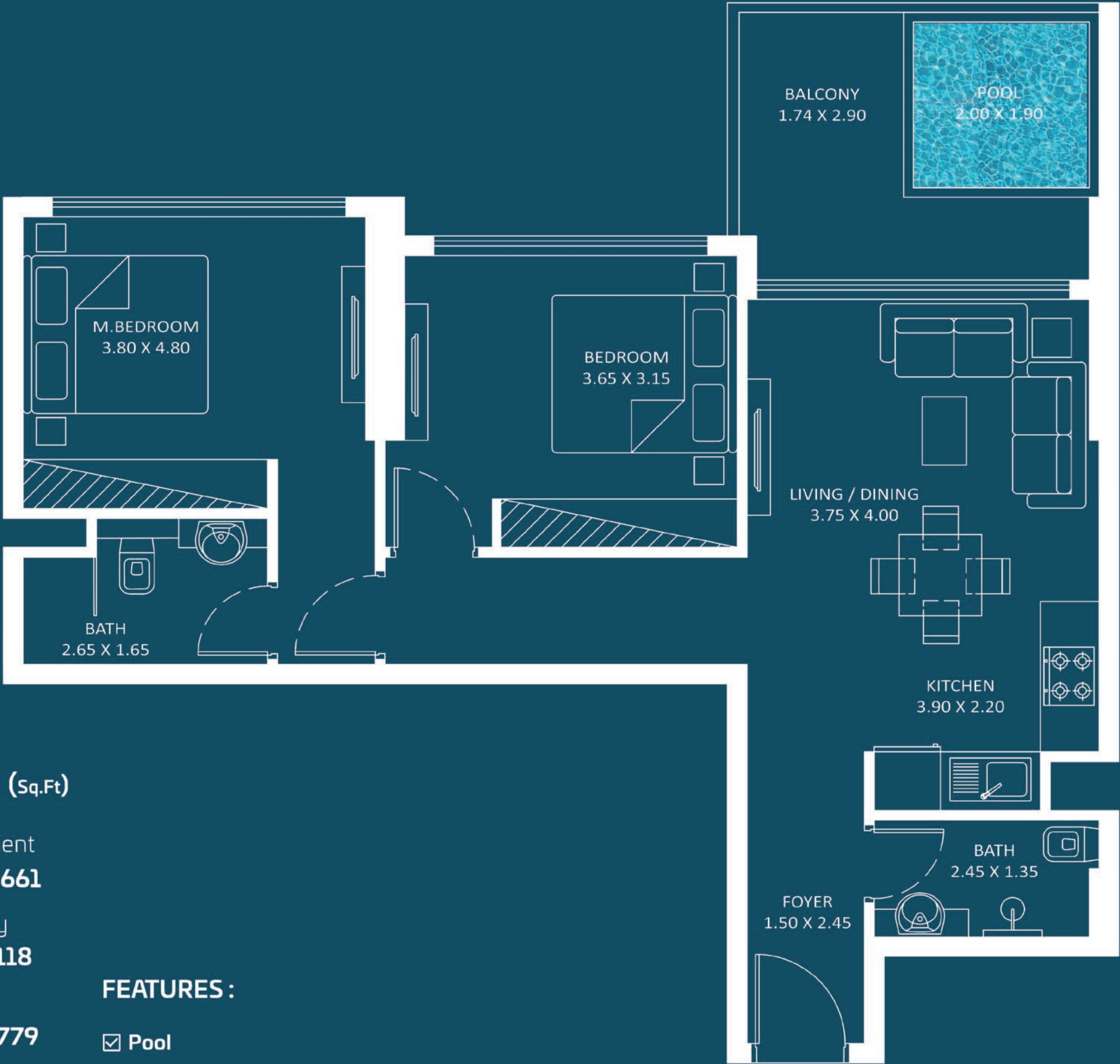
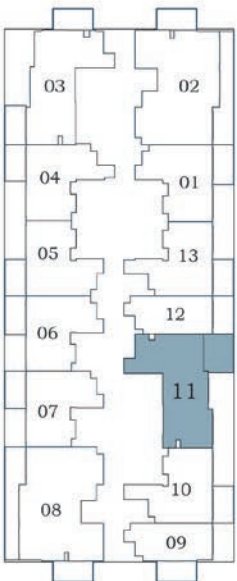

AREA (Sq.Ft)

Apartment
653 to 661

Balcony
114 to 118

Total
767 to 779

FEATURES :

☒ Pool

2 BEDROOM

TYPE - D

Floor

Oasiz 2



2 - 15

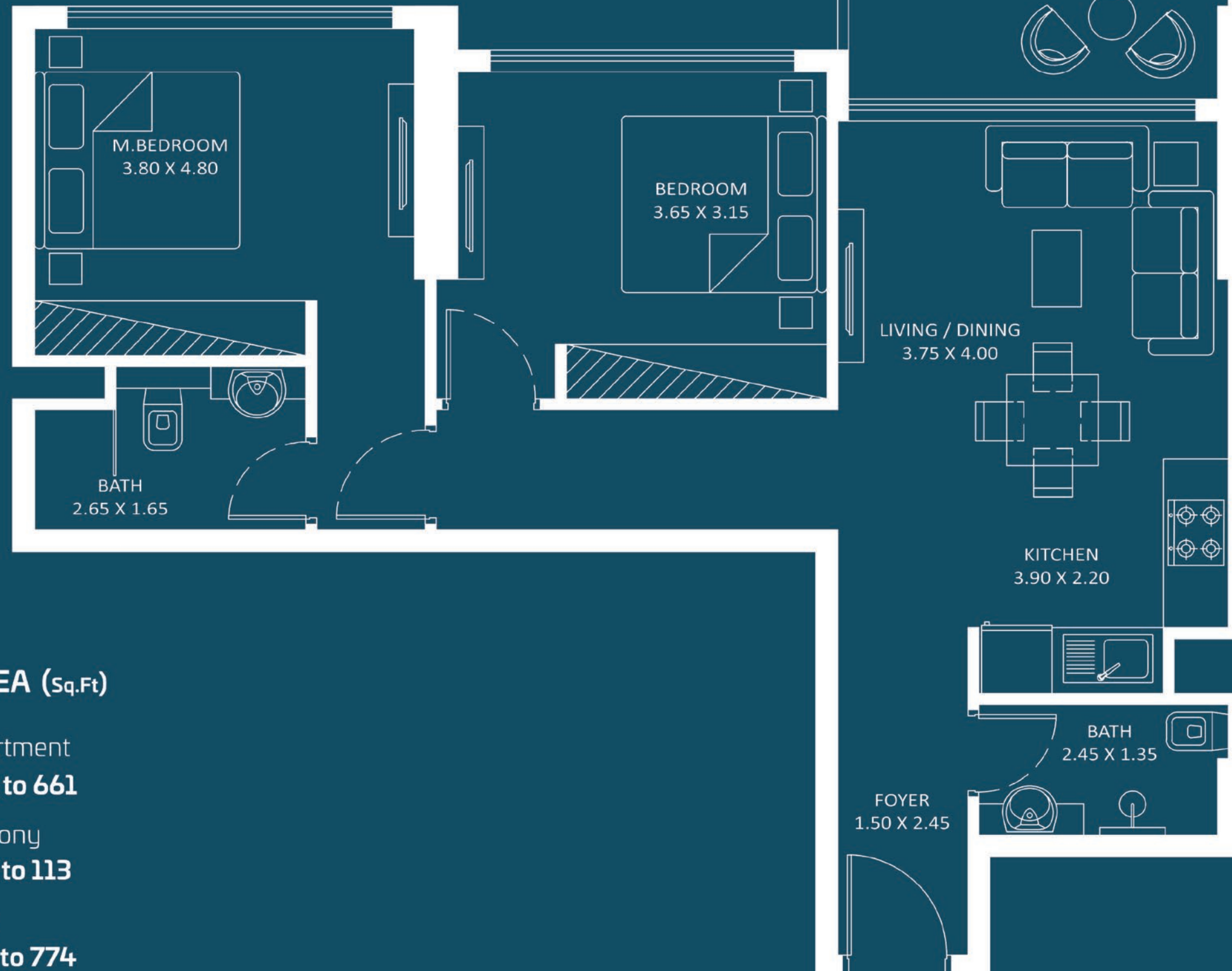
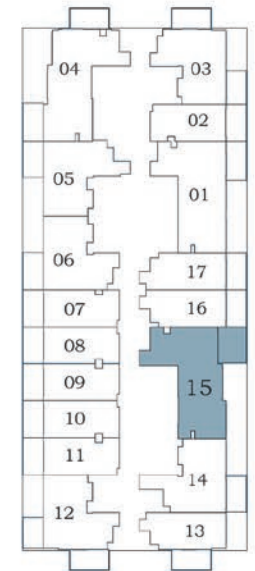

AREA (Sq.Ft)

Apartment
653 to 661

Balcony
109 to 113

Total
762 to 774

3 BEDROOM

Floor

Oasiz 2



28 - 31

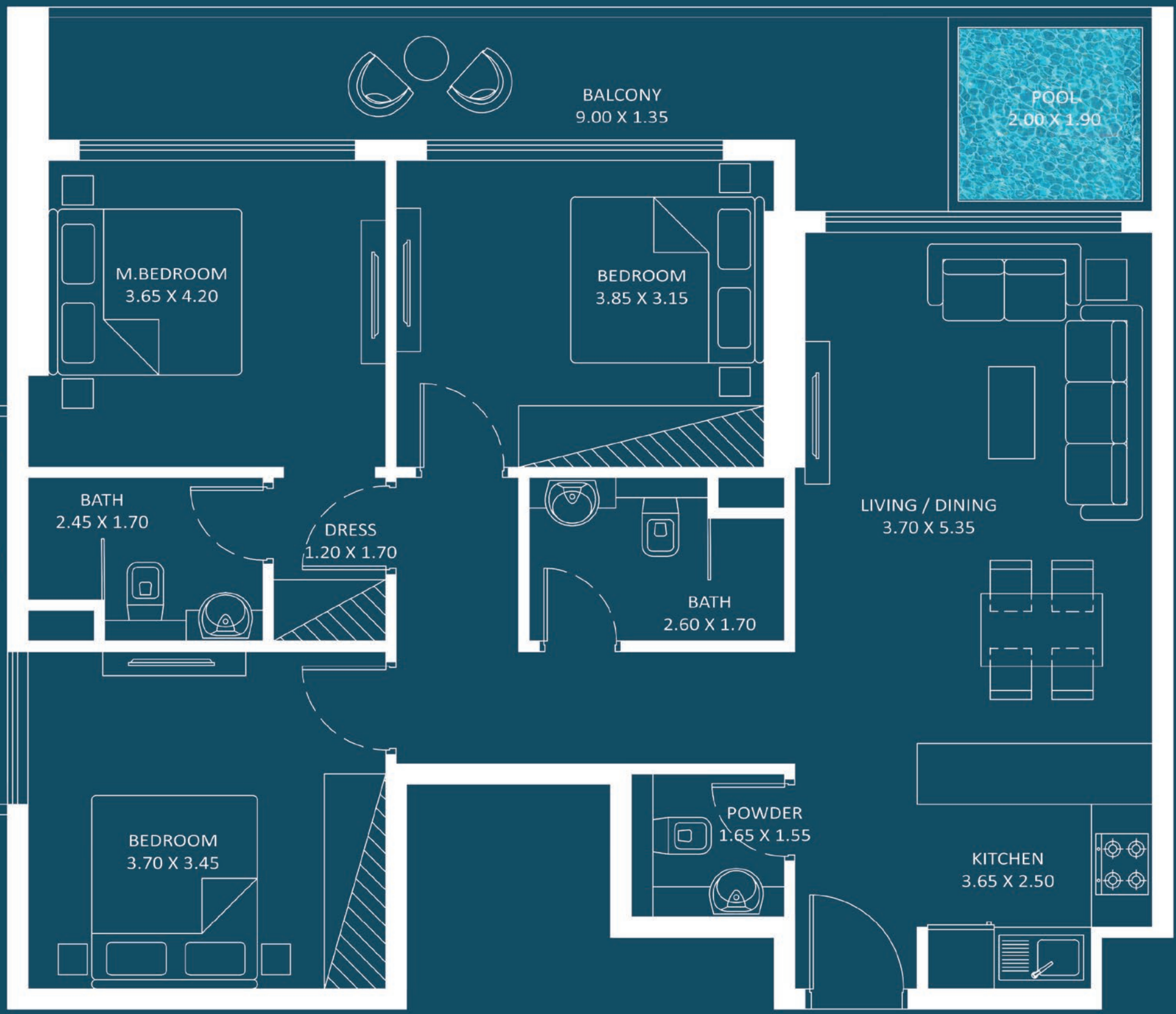
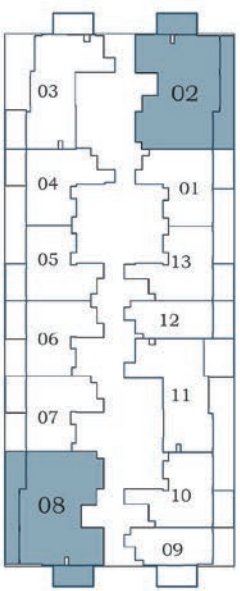

AREA (Sq.Ft)

Apartment
890 to 898

Balcony
268 to 273

Total
1,158 to 1,171

FEATURES :

☒ Pool

FLOOR 2ND - 15TH

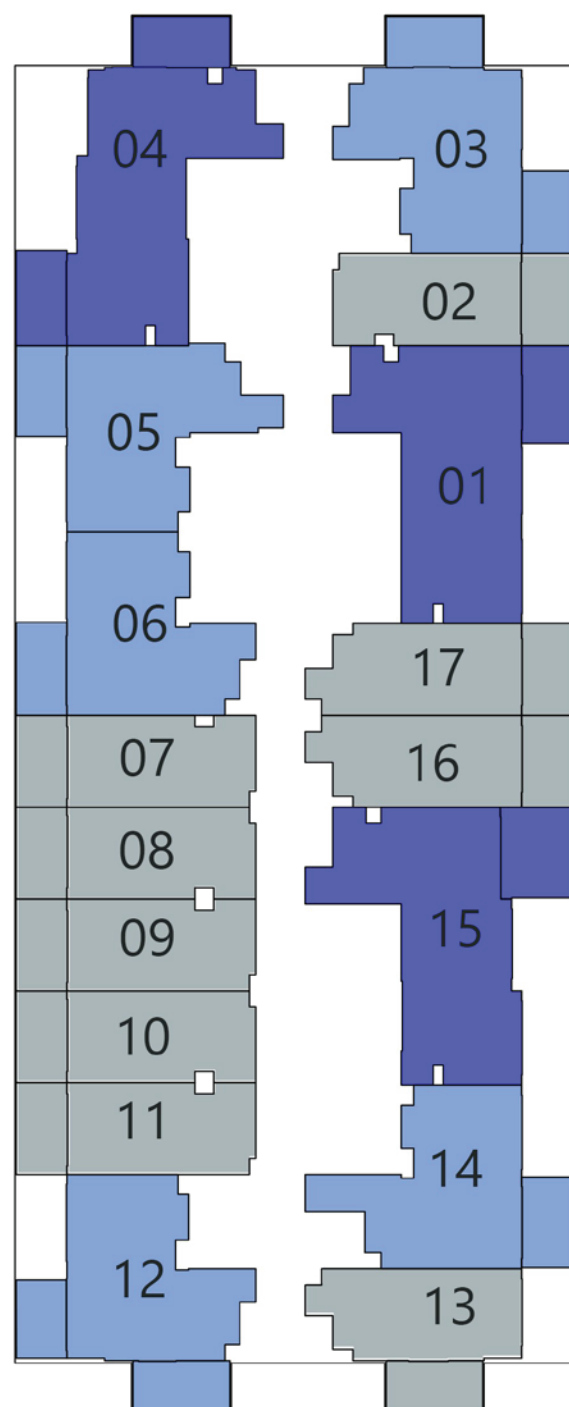

FLOOR 17TH - 27TH

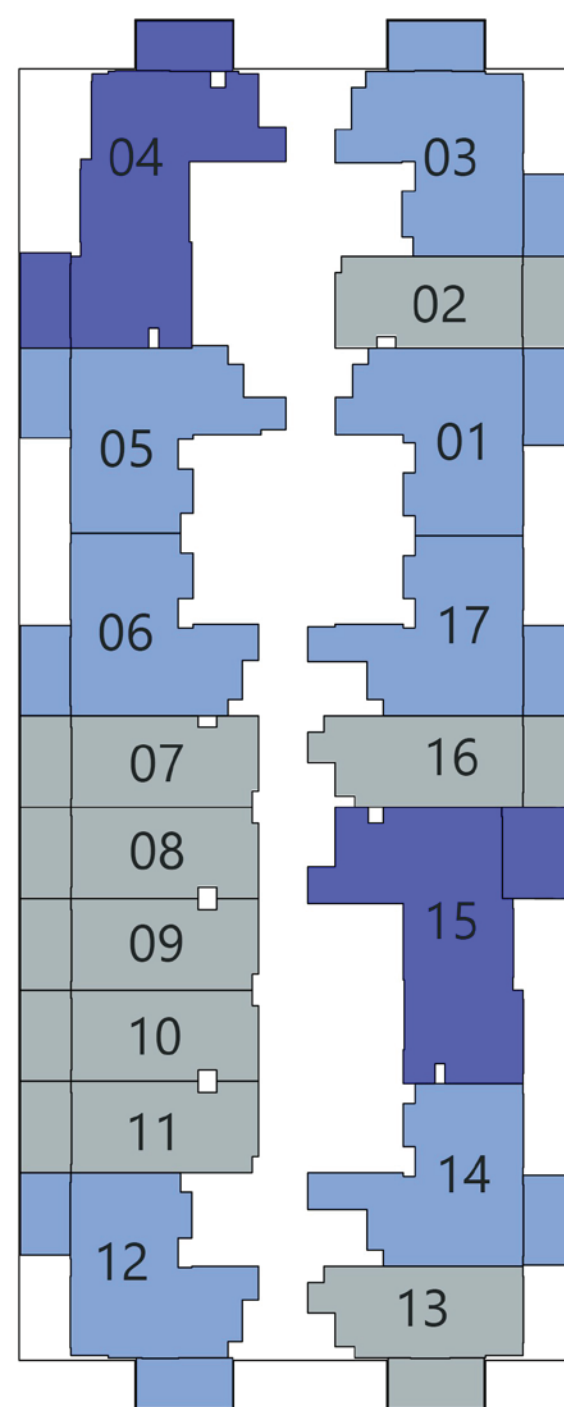

FLOOR 28TH - 31ST

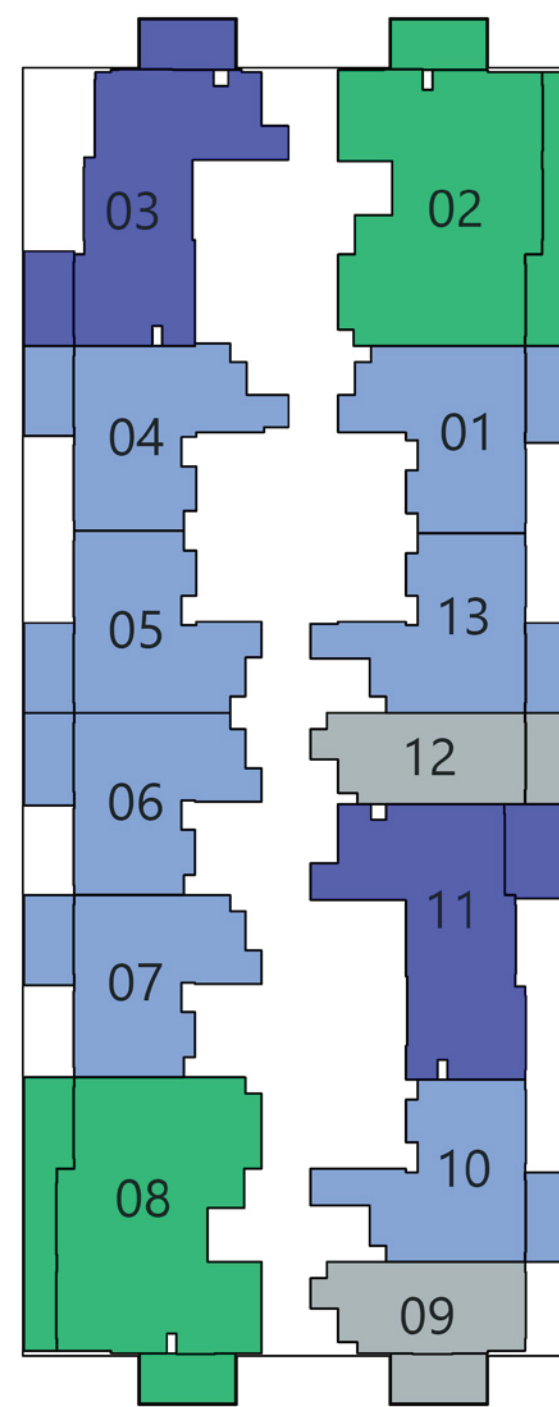

- STUDIO
- 1 BEDROOM
- 2 BEDROOMS
- 3 BEDROOMS

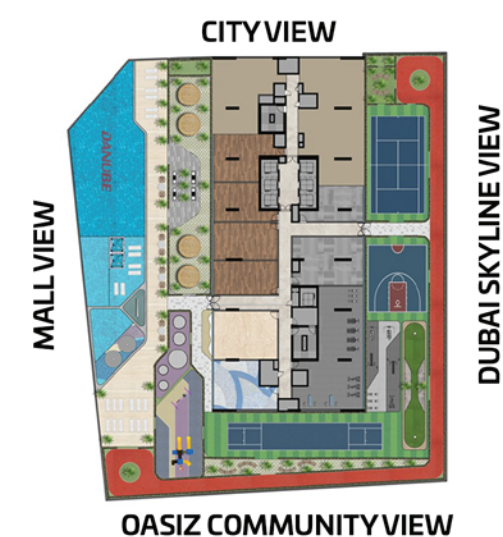

Oasiz 2

LEVEL 1

PARTY / FAMILY ZONE

- 28. Outdoor Cinema
- 29. Roof Top Cabana
- 30. Outdoor Party Hall
- 31. Indoor Party Hall
- 32. Health Bar
- 33. Male / Female Restroom



ROOF LEVEL





1. All information, materials, plans and amenities are approximate and provided for illustrative purposes only. The Developer reserves the right to make revisions to the floor plans and any features, materials, dimensions, drawings, and amenities of the project without notice.
2. Units areas, actual dimensions, layout, location, specifications of balcony, door, wardrobe or other fixtures may vary floor to floor and between units and are subject to revision by the Developer.
3. Furniture and electric devices will not be provided by the Developer, unless specified otherwise in the Unit Sale Purchase Agreement.

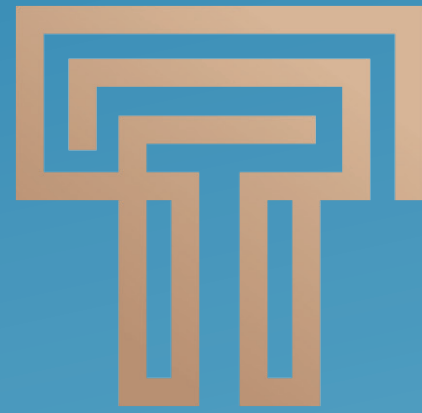

TANAMI
P R O P E R T I E S

Contact Us

☎ +971 4 248 3400, 📞 +971 55 162 3236

✉ info@tanamiproperties.ae

For More Info...

www.tanamiproperties.com/Projects/Oasiz-2-by-Danube



3405, Marina Plaza, Al Marsa Street, Dubai Marina, UAE